

High-tech is a Standard Feature



Resistant to extreme temperatures

Will not crack or peel when exposed to ultraviolet rays, built-in insulation will withstand temperatures from -40°C to 110°C.

Bright coloured exterior flaps

Provide easy identification in emergencies.

Built in finger slots for sure grip

Light weight construction

Weighs only 1.8 lb (800 gm) when empty and 4 lb. (2.0 Kg.) Complete.

Unique design

Includes all your basic first aid needs in this 13 x 13 x 4 3/4" case. (33 x 33 x 12 cm.)

Water Proof construction

Prevents Moisture, dust and water from entering.

Impact & scratch resistant material

Will withstand heavy impacts due to its high resilience factor.

Buoyancy allows it to be used as a flotation device

Environmentally safe

The Right Kit is reusable, its material recyclable and is manufactured without CFC agents.

Centre release buckles

Favours a one-handed release.

Closed cell construction

To provide abrasion and chemical resistance.

Nylon web handle

Makes it handy to carry about.

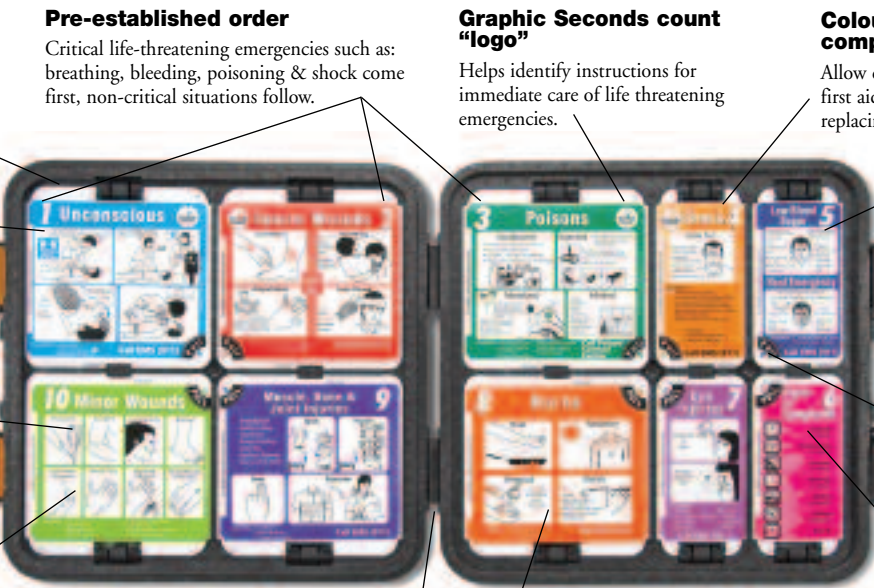

Modular system

Each compartment provides both content & instruction for specific first aid emergencies..

Pre-established order

Critical life-threatening emergencies such as: breathing, bleeding, poisoning & shock come first, non-critical situations follow.

Graphic Seconds count "logo"

Helps identify instructions for immediate care of life threatening emergencies.

Colour-coded compartments

Allow doubtless identification of first aid emergencies and simplifies replacing supplies.

Snap-on lid

Keeps contents secure, dry, fresh and ready to use in their air-tight fully identifiable bag.

Key words in bold

Provide visual stimuli to alert you to critical procedure during treatment.

Unique illustrations.

Allow quick reference without having to read the text. Universal language is used.

Finger Tab

Designed for quick one-finger opening.

Easy to follow instructions

Printed on each side of the colour coded lid, providing detailed instructions on the type of treatment offered.

Opens like a book

Have a broad view of treatment options at a glance and quick access to care.

Contents

All 200+ are exceptional, not normally available to the general public but specifically designed for first aid situations. Supplies with extended expiration dates are preferred.

SOS

Compartment contains non-prescription medication for care of the most common disabling symptoms.



151 Carlingview Drive,
Unit 5, Toronto, Ontario
Canada M9W 5S4
www.kitcarecorp.com

Call now for information on pricing and delivery

416 243-3030
1 800 387 1858 (toll free)
416 243 3082 (fax)
1 866 777 0787 (toll free fax)